

# NEBO®

## LUXTREME® SL100

### LUXTREME SL100

Our Luxtreme SL line of spotlights offer extraordinary beam distance and close range flood pattern in an ergonomic and rugged design.

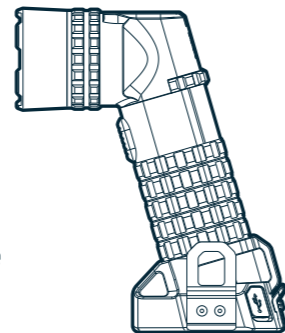

MODES	LUMENS	RUN TIME	METERS
LEP	280	6h 15m	1600
WHITE C•O•B	500	13h 40m	42
RED C•O•B	30	12h	6
LEP + WHITE C•O•B	525	10h 16m	1496

**CONTINUOUS RUN WITH 12V ADAPTER**

- One Mile Beam Distance • Mode Select Dial
- USB Rechargeable • Smart Power Control • Magnetic Base • Belt Clip • 12V Adapter
- Tripod Mount • IP67 Waterproof

**REMOVE BATTERY SPACER BEFORE OPERATION!**  
This unit uses a battery spacer during shipping. Remove before operation.

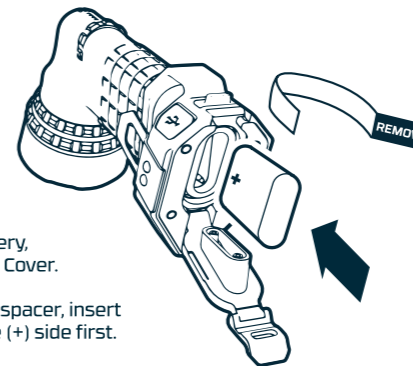

To remove the battery, unlatch the Battery Cover.

After removing the spacer, insert the battery positive (+) side first.

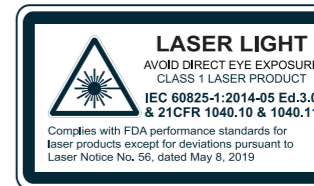

This device is a photobiological safety Risk Group 1 (RG1) product. The Maximum Permissible Viewing Exposure (MPE) is 50 seconds.

**CAUTION** - Use of controls or adjustments or performance of procedures other than those specified herein may result in hazardous radiation exposure

This product is guaranteed against all defects in workmanship and materials for the original owner for one year from the date of purchase.

Alliance Consumer Group  
5650 Alliance Gateway Freeway  
Fort Worth, TX 76177  
800.255.6061  
Made in China.



For more information, detailed video instructions, and warranty registration, visit [NEBOLIGHTS.com](http://NEBOLIGHTS.com).

#### PRODUCT GUARANTEE

If you experience a problem, please do not return to your local store. Please contact our Customer Service team at 800-255-6061 or [www.nebotools.com/contact](http://www.nebotools.com/contact).

**OPERATION**  
Rotate the Mode Select Dial to cycle through light modes:  
**Off > White COB > LEP > White COB + LEP**

Press the Trigger Button to turn the unit **On**.  
Press again to turn **Off**.  
Press and hold the Trigger Button to activate **Red COB**.

**Smart Power Control (SPC)** seamlessly transitions through light modes.

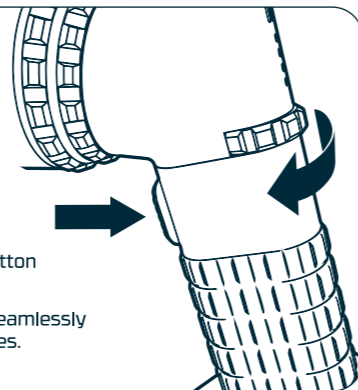

**POWER INDICATOR**  
This product uses 4 LED lights just above the Mode Select Dial.

**100% battery:** 3 green, 1 red  
**75% battery:** 2 green, 1 red  
**50% battery:** 1 green, 1 red  
**25% battery:** 1 red

Press the trigger button while Mode Select Dial is in the **Off** position to show battery life.

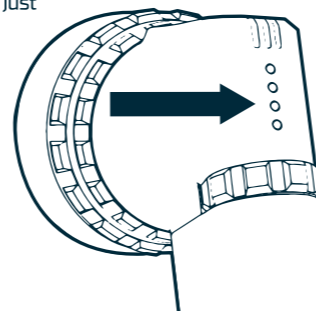

**CHARGING**  
Use the included charging cable to recharge the Luxtreme SL.

The last indicator light will flash when the unit is charging.

When charging is complete, all indicators will light continuously.

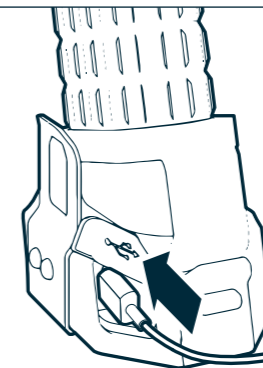

**BELT CLIP**  
The Belt Clip is designed so that it can be mounted on either side of the base.

Simply screw the Belt Clip in the desired position.

