

# User Manual

**iPROTEC**

**RMLSG**

**RAIL-MOUNT**  
sightable firearm  
green laser



#6569

**USER MANUAL**

[www.iprotec.com](http://www.iprotec.com)



## LASER LIGHT

AVOID DIRECT EYE EXPOSURE  
CLASS 3R LASER PRODUCT

<5mW 510nm, CW  
EN/IEC 60825-1 2014

Complies with FDA performance standards for laser products except for deviations pursuant to Laser Notice No. 50, dated June 24, 2007

## QUALITY GUARANTEE

This product is guaranteed against all defects in workmanship and materials for the original owner for one year from the date of purchase. Damage to or failure of the flashlight or any component thereof due to alteration, misuse, battery leakage or lack of maintenance will void any and all guarantees. Damage by leakage of batteries should be taken up with the manufacturer of the battery using their damage claim instructions. For any additional information call 1-800-255-6061.

## OPERATION

RM-LSG is equipped with 2 side buttons for easy right or left handed operation of the green laser.

1. Press either button once for HIGH mode
2. Press button second time for LOW mode
3. Press button third time to turn off

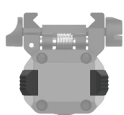

## MOUNTING INSTRUCTIONS

The RM-LSG is designed to mount on guns equipped with Picatinny or Weaver Rails. Patented universal mounting does not require tools to mount or unmount.

1. Turn slotted thumb lever screw (counter-clockwise) to widen adjustable hinge mount.
2. Press down on BOTH thumb levers to depress recoil bar.
3. Slide onto firearm rail until securely locked. Turn (clockwise) slotted thumb lever screw.

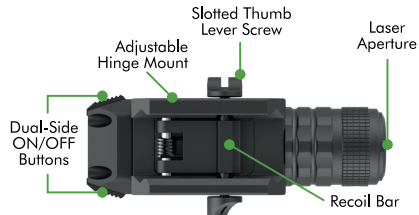

**CAUTION:** Make sure that the firearm has the safety on and is unloaded to avoid unintentional discharge. Make sure the mount is secure and test your flashlight for proper functionality.

## BATTERY INSTALLATION

The RM-LSG is powered by 1 CR123A Lithium-Metal battery. Use of a rechargeable battery may reduce run-time and/or performance.

1. To open battery compartment, unscrew the inner collar of the laser head by turning it counter-clockwise until it releases from the body (as illustrated).
2. Remove old battery and dispose of properly. Insert new battery negative end (-) toward the tail of the body of the laser unit.
3. Reattach head by turning clockwise.

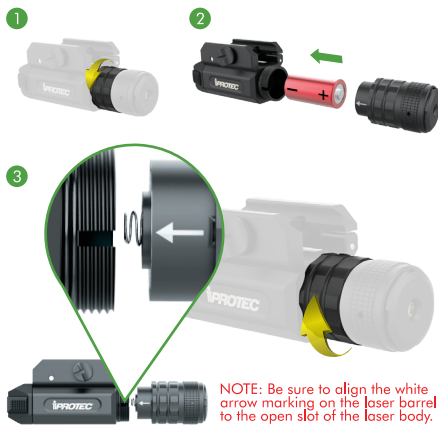

**CAUTION:** Always remove gun light from firearm before attempting to change batteries or to perform any maintenance.

## SIGHT ADJUSTMENT

### 1. Mount securely

Secure the RM-LSG firmly in place on the accessory rail without allowing any movement. Refer to "MOUNTING INSTRUCTIONS" section of this user manual.

### 2. Fix firearm & laser sight on target

For best accuracy, zeroing your laser from a fixed resting position rather than firing at the target while intermittently adjusting the laser.

### 3. Sight distance

Keeping in mind, at 15, 20 and 25 feet, the path of the laser continues to rise. As the distance increases, you will be farther off target. Sight in at 25 feet. The laser's point of impact shift will be more gradual, and even at close range you won't be more than an inch or so off target.

### 4. Fine-tune adjustments

Fine-tune your laser by making very small adjustments to windage/elevation screws.

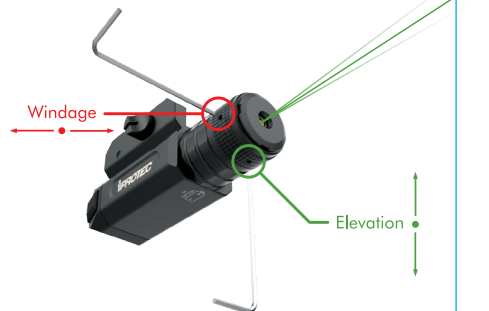

**NOTE:** Before you begin fine-tuning the laser, have this User Manual on hand to reference the windage and elevation sight screws.