

## Tele-Titan™

Instruction Sheet: P/N 12507C

platinumtools.com  
Tel: 800.749.5783

Platinum Tools  
North Carolina, USA



- 1) To unlock the Tele-Titan, squeeze handle and hold while pushing lock pin to other side. (Fig 1). Release handle. Ready to terminate!**

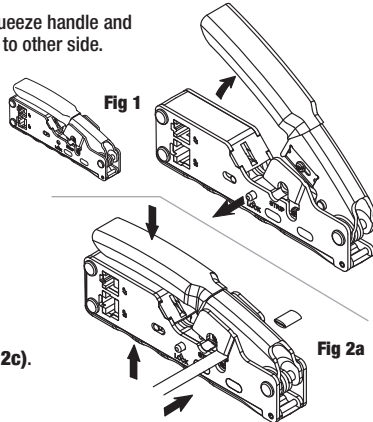

- 2) Prep the cable:**  
**A.** To strip flat satin, insert thru the 2 strip blades and out past the cut side. Squeeze handle down, slightly release & hold. Pull cable out & away from tool (Fig2a). When stripping 4 or 6 conductor flat satin, re-cut conductor's to 1/4". Use cutter on cut side. (Fig 2c).

continued on back

## Tele-Titan™

Instruction Sheet: P/N 12507C

platinumtools.com  
Tel: 800.749.5783

Platinum Tools  
North Carolina, USA



- 1) To unlock the Tele-Titan, squeeze handle and hold while pushing lock pin to other side. (Fig 1). Release handle. Ready to terminate!**

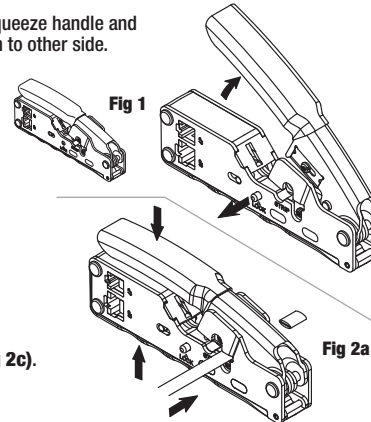

- 2) Prep the cable:**  
**A.** To strip flat satin, insert thru the 2 strip blades and out past the cut side. Squeeze handle down, slightly release & hold. Pull cable out & away from tool (Fig2a). When stripping 4 or 6 conductor flat satin, re-cut conductor's to 1/4". Use cutter on cut side. (Fig 2c).

continued on back

## Tele-Titan™

Instruction Sheet: P/N 12507C

platinumtools.com  
Tel: 800.749.5783

Platinum Tools  
North Carolina, USA



- 1) To unlock the Tele-Titan, squeeze handle and hold while pushing lock pin to other side. (Fig 1). Release handle. Ready to terminate!**

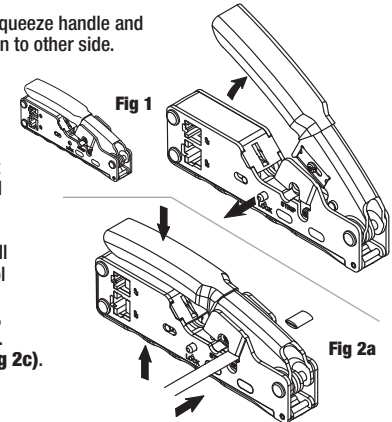

- 2) Prep the cable:**  
**A.** To strip flat satin, insert thru the 2 strip blades and out past the cut side. Squeeze handle down, slightly release & hold. Pull cable out & away from tool (Fig2a). When stripping 4 or 6 conductor flat satin, re-cut conductor's to 1/4". Use cutter on cut side. (Fig 2c).

continued on back

## Tele-Titan™

Instruction Sheet: P/N 12507C

platinumtools.com  
Tel: 800.749.5783

Platinum Tools  
North Carolina, USA



- 1) To unlock the Tele-Titan, squeeze handle and hold while pushing lock pin to other side. (Fig 1). Release handle. Ready to terminate!**

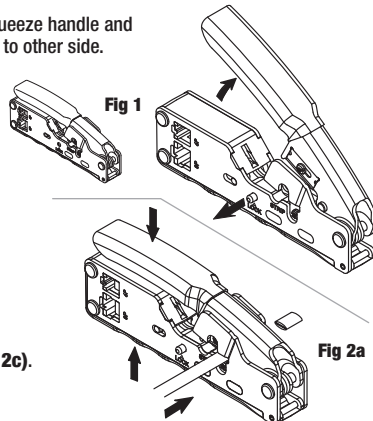

- 2) Prep the cable:**  
**A.** To strip flat satin, insert thru the 2 strip blades and out past the cut side. Squeeze handle down, slightly release & hold. Pull cable out & away from tool (Fig2a). When stripping 4 or 6 conductor flat satin, re-cut conductor's to 1/4". Use cutter on cut side. (Fig 2c).

continued on back

## Tele-Titan™

Instruction Sheet: P/N 12507C

platinumtools.com  
Tel: 800.749.5783

Platinum Tools  
North Carolina, USA



- 1) To unlock the Tele-Titan, squeeze handle and hold while pushing lock pin to other side. (Fig 1). Release handle. Ready to terminate!**

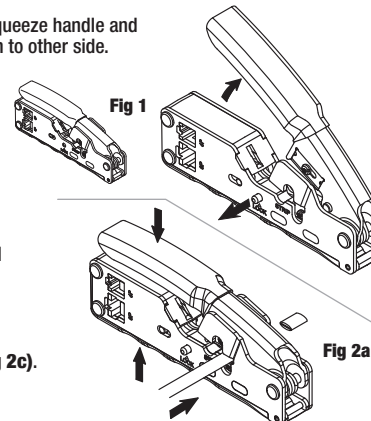

- 2) Prep the cable:**  
**A.** To strip flat satin, insert thru the 2 strip blades and out past the cut side. Squeeze handle down, slightly release & hold. Pull cable out & away from tool (Fig2a). When stripping 4 or 6 conductor flat satin, re-cut conductor's to 1/4". Use cutter on cut side. (Fig 2c).

continued on back

## Tele-Titan™

Instruction Sheet: P/N 12507C

platinumtools.com  
Tel: 800.749.5783

Platinum Tools  
North Carolina, USA



- 1) To unlock the Tele-Titan, squeeze handle and hold while pushing lock pin to other side. (Fig 1). Release handle. Ready to terminate!**

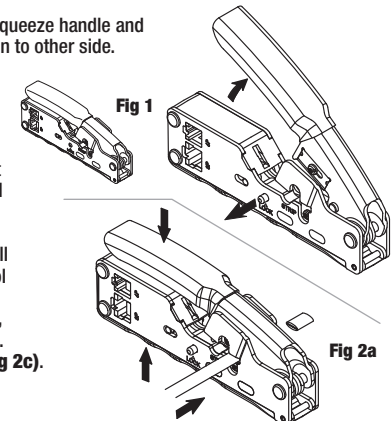

- 2) Prep the cable:**  
**A.** To strip flat satin, insert thru the 2 strip blades and out past the cut side. Squeeze handle down, slightly release & hold. Pull cable out & away from tool (Fig2a). When stripping 4 or 6 conductor flat satin, re-cut conductor's to 1/4". Use cutter on cut side. (Fig 2c).

continued on back

- B.** To strip twisted pair, insert into round stripping cavity. **(Fig 2b)**. Squeeze handle until blade slightly cuts jacket, hold, rotate tool clockwise & cable counterclockwise.  
**NOTE:** scoring the jacket prevents nicking the conductors! Untwist pairs, remove kinks, configure to spec A or B. Use cutter to trim, 1/2" for Cat5e & 3/16" for CAT6.

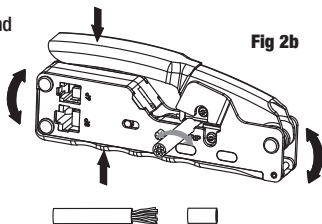

### 3) Terminate the connector:

- A.** Insert the prepped cable into the proper crimp cavity/port, 8P for the RJ45's and 6P for the RJ12's and RJ11's. See **(Fig 3)**.  
**B.** Make sure connector is fully seated into the crimp cavity/port and hold in position until crimped.  
**C.** Squeeze handle all the way down until it bottoms out. See **(Fig 4)**. Termination is complete!

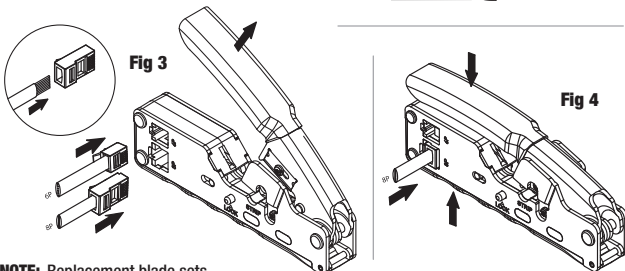

**NOTE:** Replacement blade sets are available. Order PN 12507BLC ©2022 Platinum Tools. All rights reserved. 12507C\_IS\_V1\_0222

- B.** To strip twisted pair, insert into round stripping cavity. **(Fig 2b)**. Squeeze handle until blade slightly cuts jacket, hold, rotate tool clockwise & cable counterclockwise.  
**NOTE:** scoring the jacket prevents nicking the conductors! Untwist pairs, remove kinks, configure to spec A or B. Use cutter to trim, 1/2" for Cat5e & 3/16" for CAT6.

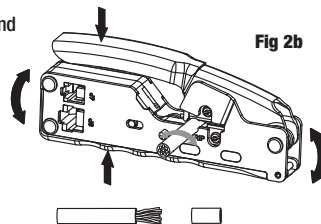

### 3) Terminate the connector:

- A.** Insert the prepped cable into the proper crimp cavity/port, 8P for the RJ45's and 6P for the RJ12's and RJ11's. See **(Fig 3)**.  
**B.** Make sure connector is fully seated into the crimp cavity/port and hold in position until crimped.  
**C.** Squeeze handle all the way down until it bottoms out. See **(Fig 4)**. Termination is complete!

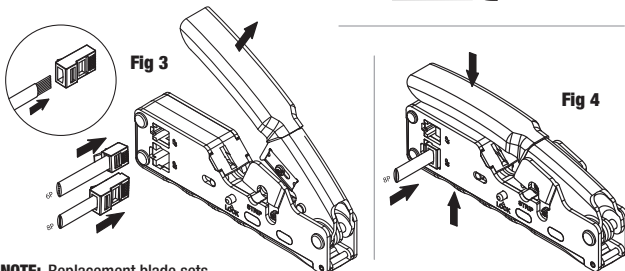

**NOTE:** Replacement blade sets are available. Order PN 12507BLC ©2022 Platinum Tools. All rights reserved. 12507C\_IS\_V1\_0222

- B.** To strip twisted pair, insert into round stripping cavity. **(Fig 2b)**. Squeeze handle until blade slightly cuts jacket, hold, rotate tool clockwise & cable counterclockwise.  
**NOTE:** scoring the jacket prevents nicking the conductors! Untwist pairs, remove kinks, configure to spec A or B. Use cutter to trim, 1/2" for Cat5e & 3/16" for CAT6.

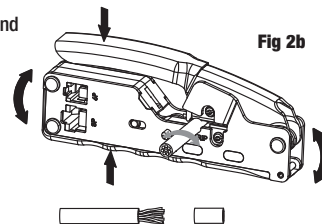

### 3) Terminate the connector:

- A.** Insert the prepped cable into the proper crimp cavity/port, 8P for the RJ45's and 6P for the RJ12's and RJ11's. See **(Fig 3)**.  
**B.** Make sure connector is fully seated into the crimp cavity/port and hold in position until crimped.  
**C.** Squeeze handle all the way down until it bottoms out. See **(Fig 4)**. Termination is complete!

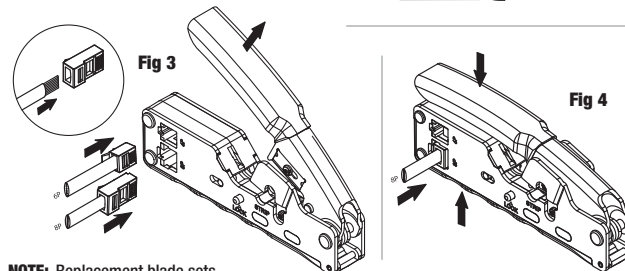

**NOTE:** Replacement blade sets are available. Order PN 12507BLC ©2022 Platinum Tools. All rights reserved. 12507C\_IS\_V1\_0222

- B.** To strip twisted pair, insert into round stripping cavity. **(Fig 2b)**. Squeeze handle until blade slightly cuts jacket, hold, rotate tool clockwise & cable counterclockwise.  
**NOTE:** scoring the jacket prevents nicking the conductors! Untwist pairs, remove kinks, configure to spec A or B. Use cutter to trim, 1/2" for Cat5e & 3/16" for CAT6.

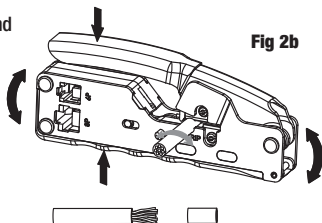

### 3) Terminate the connector:

- A.** Insert the prepped cable into the proper crimp cavity/port, 8P for the RJ45's and 6P for the RJ12's and RJ11's. See **(Fig 3)**.  
**B.** Make sure connector is fully seated into the crimp cavity/port and hold in position until crimped.  
**C.** Squeeze handle all the way down until it bottoms out. See **(Fig 4)**. Termination is complete!

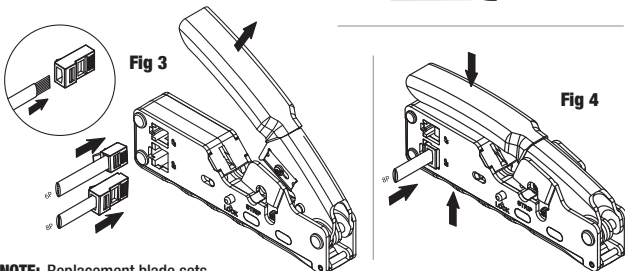

**NOTE:** Replacement blade sets are available. Order PN 12507BLC ©2022 Platinum Tools. All rights reserved. 12507C\_IS\_V1\_0222

- B.** To strip twisted pair, insert into round stripping cavity. **(Fig 2b)**. Squeeze handle until blade slightly cuts jacket, hold, rotate tool clockwise & cable counterclockwise.  
**NOTE:** scoring the jacket prevents nicking the conductors! Untwist pairs, remove kinks, configure to spec A or B. Use cutter to trim, 1/2" for Cat5e & 3/16" for CAT6.

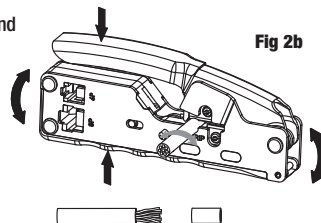

### 3) Terminate the connector:

- A.** Insert the prepped cable into the proper crimp cavity/port, 8P for the RJ45's and 6P for the RJ12's and RJ11's. See **(Fig 3)**.  
**B.** Make sure connector is fully seated into the crimp cavity/port and hold in position until crimped.  
**C.** Squeeze handle all the way down until it bottoms out. See **(Fig 4)**. Termination is complete!

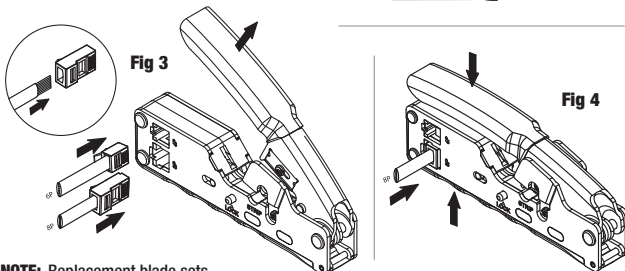

**NOTE:** Replacement blade sets are available. Order PN 12507BLC ©2022 Platinum Tools. All rights reserved. 12507C\_IS\_V1\_0222

- B.** To strip twisted pair, insert into round stripping cavity. **(Fig 2b)**. Squeeze handle until blade slightly cuts jacket, hold, rotate tool clockwise & cable counterclockwise.  
**NOTE:** scoring the jacket prevents nicking the conductors! Untwist pairs, remove kinks, configure to spec A or B. Use cutter to trim, 1/2" for Cat5e & 3/16" for CAT6.

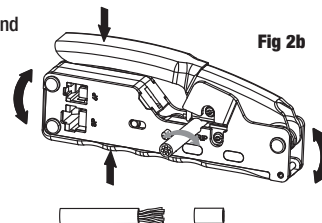

### 3) Terminate the connector:

- A.** Insert the prepped cable into the proper crimp cavity/port, 8P for the RJ45's and 6P for the RJ12's and RJ11's. See **(Fig 3)**.  
**B.** Make sure connector is fully seated into the crimp cavity/port and hold in position until crimped.  
**C.** Squeeze handle all the way down until it bottoms out. See **(Fig 4)**. Termination is complete!

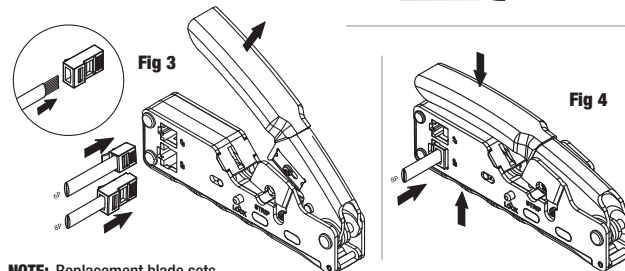

**NOTE:** Replacement blade sets are available. Order PN 12507BLC ©2022 Platinum Tools. All rights reserved. 12507C\_IS\_V1\_0222