

PLATINUM TOOLS®

Tele-Titan™

Instruction Sheet: P/N 12507C

platinumtools.com
Tel: 800.749.5783

Platinum Tools
North Carolina, USA



- 1)** To unlock the Tele-Titan, squeeze handle and hold while pushing lock pin to other side.
(Fig 1). Release handle.
Ready to terminate!

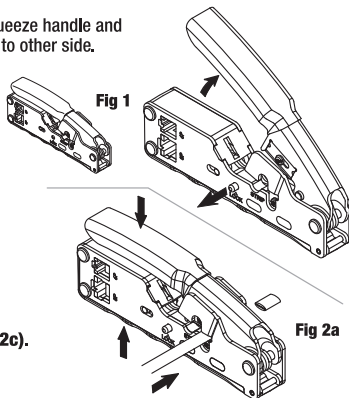

2) Prep the cable:

A. To strip flat satin, insert thru the 2 strip blades and out past the cut side. Squeeze handle down, slightly release & hold. Pull cable out & away from tool **(Fig2a)**. When stripping 4 or 6 conductor flat satin, re-cut conductor's to 1/4". Use cutter on cut side. **(Fig 2c)**.

continued on back

- B.** To strip twisted pair, insert into round stripping cavity. (**Fig 2b**). Squeeze handle until blade slightly cuts jacket, hold, rotate tool clockwise & cable counterclockwise.

NOTE: scoring the jacket prevents nicking the conductors! Untwist pairs, remove kinks, configure to spec A or B. Use cutter to trim, 1/2" for Cat5e & 3/16" for CAT6.

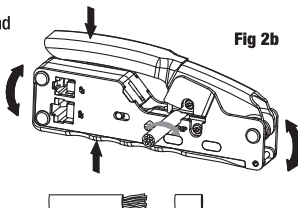

3) Terminate the connector:

- A.** Insert the prepped cable into the proper crimp cavity/port, 8P for the RJ45's and 6P for the RJ12's and RJ11's. See (**Fig 3**).
- B.** Make sure connector is fully seated into the crimp cavity/port and hold in position until crimped.
- C.** Squeeze handle all the way down until it bottoms out. See (**Fig 4**). Termination is complete!

Fig 2c

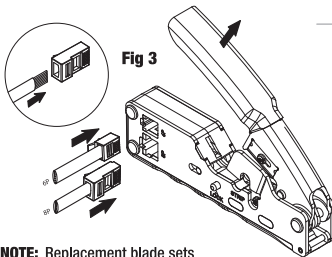
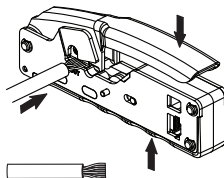

Fig 3

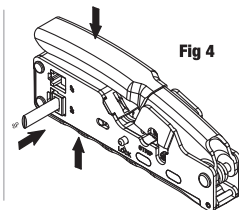

Fig 4

NOTE: Replacement blade sets are available. Order PN 12507BLC